



PRODUCTS / E-SIGNATURE

Speed Admissions & Bedside Consent with Access's E-Signature

Obtain a Secure Signature as Part of a Paperless Electronic Forms Management Process

At registration, patients are normally required to sign various pre-printed forms, with each generating a hard copy duplicate that is processed and filed in the medical records or HIM department. If forms are misplaced or inaccessible, the patient must complete the same forms again. It can be difficult to secure hard copies as they move throughout the facility.

With Access e-Signature, hospitals obtain a secure, legally acceptable patient signature on a tablet device or clipboard, facilitating a one-time paperless admissions process that enhances the patient experience. Not just applicable in patient registration, e-Signature can be used on clinical floors to obtain bedside consent, at specialty clinics and throughout the hospital.

With e-Signature, your facility can:

- Speed processes in patient registration, at patients' bedsides and anywhere else patients sign forms and documents
- Ensure tamper-proof encryption and authenticity of digital signatures in keeping with Joint Commission and HIPAA standards
- Protect patients' privacy by managing their forms and signatures electronically
- Improve the patient experience by eliminating the hassle of manually completing forms packets
- Eliminate the financial, productivity and environmental costs associated with managing paper forms
- Extend the value of Access's Patient Flow System (PFS), the industry-leading electronic forms management suite

Flexible E-Signature Options

To meet the varying needs of healthcare facilities, we offer three hardware options to use in conjunction with our e-Signature software. Hospitals can choose from any combination of these devices to deploy e-Signature.

E-Clipboard

This paper-based device is connected via USB to the registrar's computer. At admission, the registrar prints a form packet, slips it under the lever of the clipboard and hands it to the patient to sign. When the patient signs the paper form, the captured signature shows up on the registrar's screen. The patient is given the paper copy with their signature on it, while Access's Image Portal ports the electronic version into the document management system.

Customers and patients like the e-Clipboard because you still get the familiarity of "ink on paper" but also a secure electronic signature.

E-Signature Pad

The LCD paperless module is an e-signature device for those facilities that don't want to print forms. With LCD there are two screens: one for registrars and another for patients. The registrar brings up the forms requiring signatures and inputs the patient's information. He or she then brings up the forms on the screen for the patient to review. Then the patient signs on a 4x5-inch LCD pad, and the registrar and patient see the signature on the form.

The registrar now has all the information needed to complete admission, and the forms can be ported directly into the document management system using Access's Image Portal.

Tablet PC

Many hospitals offer tablet PCs on clinical floors, and e-Signature gives them a way to capture signatures electronically for bedside consent using these portable devices. As they're wireless, tablet PCs offer ultimate mobility and convenience.

Tablet PCs utilize Access's e-Forms Repository (EFR) at nurses' stations to bring up forms that patients need to sign at their bedside. Following signature, a nurse can go back to the station and print a copy of the form for the patient, while Access's Image Portal interfaces the form directly into the document management system to make it part of the electronic medical record (EMR).

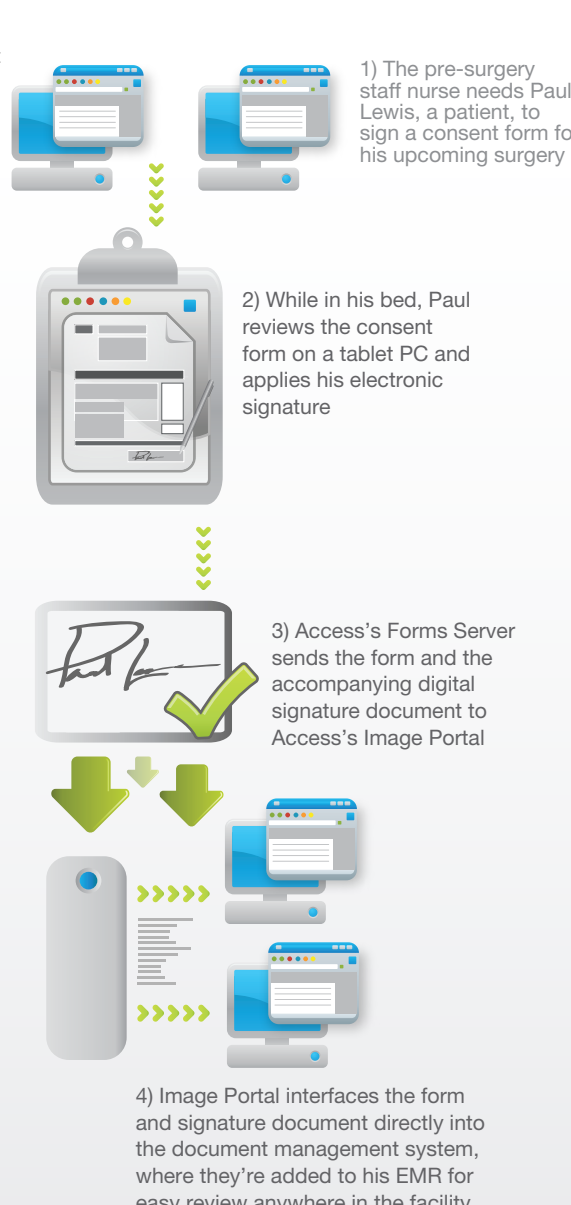

Reasons to use e-Signature Instead of Handwritten Authorization

For years, hospitals have obtained hand-written signatures on forms and documents from patients and staff members. Switching to electronic signatures offers a number of advantages, including:

- Ensuring that signatures are not altered, in keeping with regulatory requirements
- Eliminating the need to print, duplicate, transport and store hard copies of forms
- Allowing patients and staff members to sign forms more quickly
- Electronic forms aren't misplaced like paper versions, so patients and personnel don't need to sign them more than once
- E-forms requiring electronic signatures are more portable than paper versions needing handwritten signatures

Improving the Patient Experience at Tomball Regional

“Registration was so much quicker and easier with Access’s e-Signature because everything was right there on the screen and just required a quick electronic signature. I’m used to filling out a stack of forms and waiting at least 30 minutes when I go somewhere for treatment, but this time it took less than five minutes.”

Mary Udy
Patient
Tomball Regional Hospital

As part of its electronic forms solution, Tomball Regional deployed Access’s e-Signature module, which enables clerks to obtain a secure, legally accept-able sig-nature for each patient. The software supporting e-Signature ensures tamper-proof encryption and authen-ticity of digital signatures and their associated source documents. This helps protect patient privacy and supports Tomball Regional’s compliance with HIPAA and Joint Commission requirements.

Using e-Signature is improving the patient experience at Tomball Regional by speeding the registration process and removing the hassle of patients dealing with paper forms packets. A further benefit is the reduction in paper use, duplication and waste at the facility’s admissions desks, which used to inhibit staff productivity and drive up financial and environmental costs.



Quickly Complete Forms Authorization

Access’s e-Signature can be used on almost any form or document in your facility. Below is a list of just a few examples:

- Patient demographics/registration packets
- Consent to treat
- Progress notes
- History and physicals
- Bedside consent
- Home care documents
- Pre-registration forms
- HIPAA privacy forms
- Patient questionnaires
- Fee sheets
- Super bills
- Nursing assessments
- Discharge summaries
- Pain assessments
- Emergency department documents
- MRI questionnaires